

2no. ADVANCE WARNING SIGNS TO BE INSTALLED PRIOR TO ROAD CLOSURE (DATE/DURATION TBC BY CLIENT)

**This Road Will be closed On xx/xx/xx for xxxxxx**

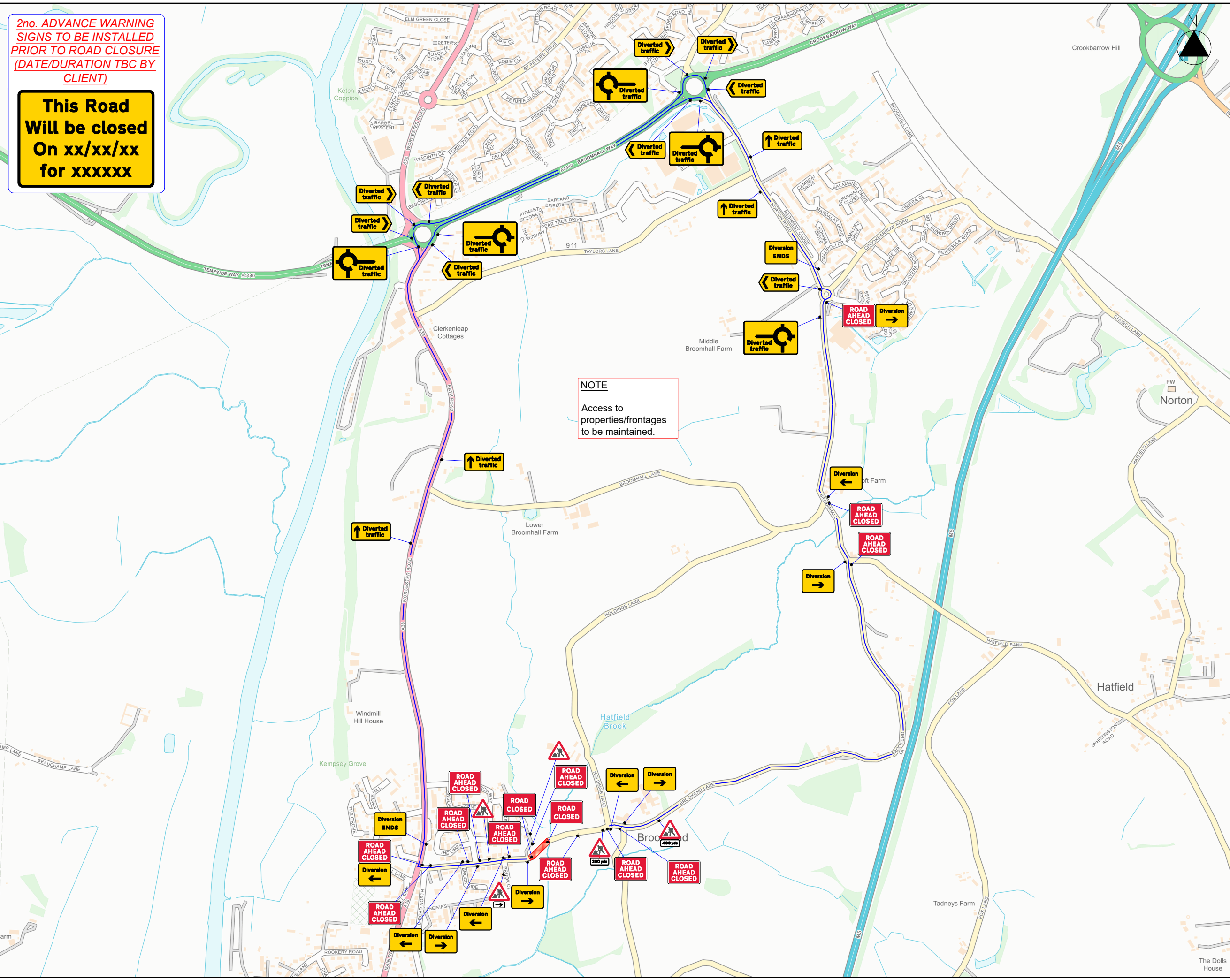

**NOTES:**

- All traffic signs shall comply with Chapter 8 of the Traffic Signs Manual
- All traffic management equipment shall be provided by the Contractor, unless otherwise specified.
- All signs shall be positioned so as not to be obscured by any other objects and shall not obstruct any other sign, permanent or temporary as much as is reasonably practicable.

**KEY:**

- SIGN
- CLOSED AREA
- DIVERSION

**SIGN SCHEDULE:**

Qty: 5 Ref: 2702 Start of temporary diversion route	
Qty: 5 Ref: 2702 Start of temporary diversion route	
Qty: 2 Ref: 2702 End of temporary diversion route	
Qty: 4 Ref: 2703 Direction of temporary diversion route from junction ahead	
Qty: 4 Ref: 2704 Direction of temporary diversion route	
Qty: 5 Ref: 2704 Direction of temporary diversion route	
Qty: 2 Ref: 2706 Roundabout ahead leading to temporary diversion route	
Qty: 3 Ref: 2706 Roundabout ahead leading to temporary diversion route	
Qty: 1 Ref: 572 Distance ahead to hazard	
Qty: 1 Ref: 572 Distance ahead to hazard	
Qty: 1 Ref: 573 Direction to hazard right	
Qty: 5 Ref: 7001 Road works ahead	
Qty: 12 Ref: 7010-FP-13.9 Nature of temporary hazard ahead - Road Ahead Closed	
Qty: 2 Ref: 7010-FP-13.9 Nature of temporary hazard ahead - Road Closed	

REV: DESCRIPTION: BY: DATE:



CLIENT: **TOUCHSTONE CIVIL ENGINEERING**

PROJECT: BROOKEND ROAD KEMPSEY, WORCESTERSHIRE

POST CODE: WR5 3UZ  
What3Words: vowed.writing.comply



TITLE: ROAD CLOSURE / DIVERSION

SCALE @ A3: NTS DATE: 03/02/2026 DRAWN BY: TH CHECKED BY: MR

DRAWING NO: ASP 17018.001 REVISION: A